

**PETITION TO CLOSE COUNTY ROAD
LOCATED IN PRECINCT # 3.**

WE, the undersigned being eight landowners in Precinct No. 3 of Fannin County, Texas, hereby petition (pursuant to Section 251.051 of the Texas Transportation Code) for the discontinuance and closure of an existing road in said Precinct as defined and located on the map attached hereto and incorporated herein by reference for all purposes:

DESCRIPTION:

Approximately 2.36 miles (12,461') of County Road 3610 beginning at FM 1550 and extending south to the end of County Road 3610. Said County Road located entirely within the footprint of the Lake Ralph Hall Project.

NAME / ADDRESS

SIGNATURE

Name: Upper Trinity Regional Water District
Address: PO Box 305
Lewisville, TX 75067

Larry N. Patterson
Larry N. Patterson, Executive Director

Name: H. L. Milton
Address: 11372 E. FM 1550
Honey Grove, TX 75446

A. L. Milton

Name: SYLVIA A. WISHARD
Address: 10973 E FM 1550
LADONIA TX 75449

Sylvia A. Wishard

Name: Robert Milton
Address: 8006 Hwy 34
Ladonia, TX 75449

Robert Milton

Name: Ruth Ann Jones
Address: 11395 E FM 1550
Honey Grove, TX 75446

Ruth Ann Jones

Name: Carol Wishard
Address: 285 CR 3489
Honey Grove, TX 75446

Carol Wishard

Name: Thomas Wishard
Address: 285 CR 3489
Honey Grove, TX 75446

Thomas Wishard

Name: VIRGINIA RUSSELL
Address: 10907 Hwy 34
LADONIA TX 75449

Virginia Russell

(Each signature must have names printed and complete addresses stated.)

POSTED this 30th day of March, 2021, at the north door of the Fannin County Courthouse and two other places in the vicinity of road petitioned to be discontinued herein.

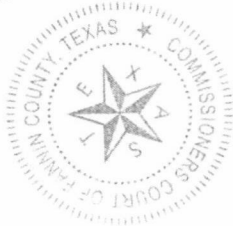

Tammy Biggar
Tammy Biggar County Clerk
Fannin County, Texas

County Maintained Road
Other Road
Grid Line

Fannin County, Texas

94

Scale 1 in = 2000 ft

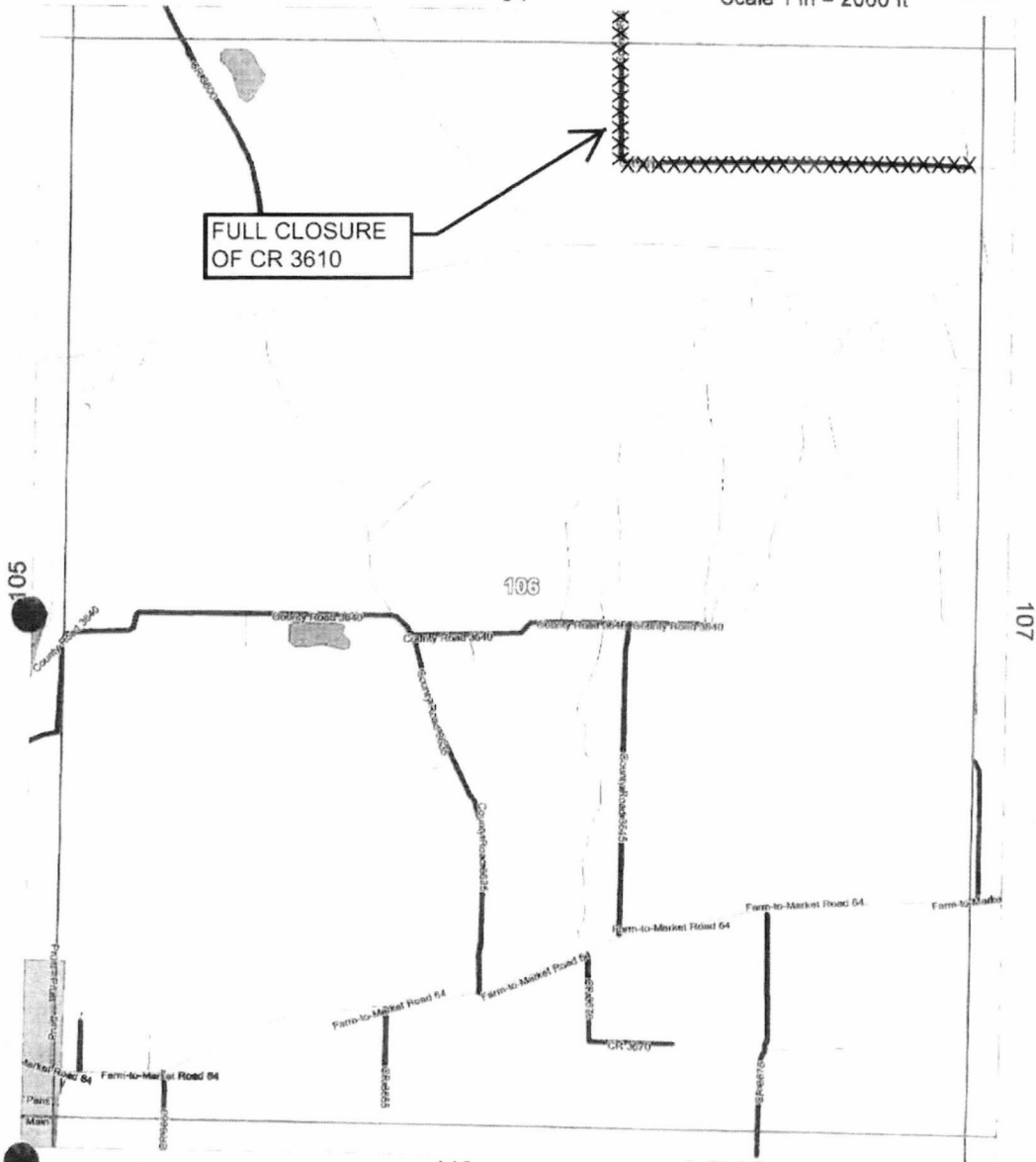

Allison, Bass & Assoc.
512-482-0701
R.Bass@Allison-Bass.com

118

Numbers Along Margins reflect
Page # of Adjacent Map Grids

3-Nov-2005

Map # 106

County Maintained Road
Other Road
Grid Line

Fannin County, Texas

82

Scale 1 in = 2000 ft

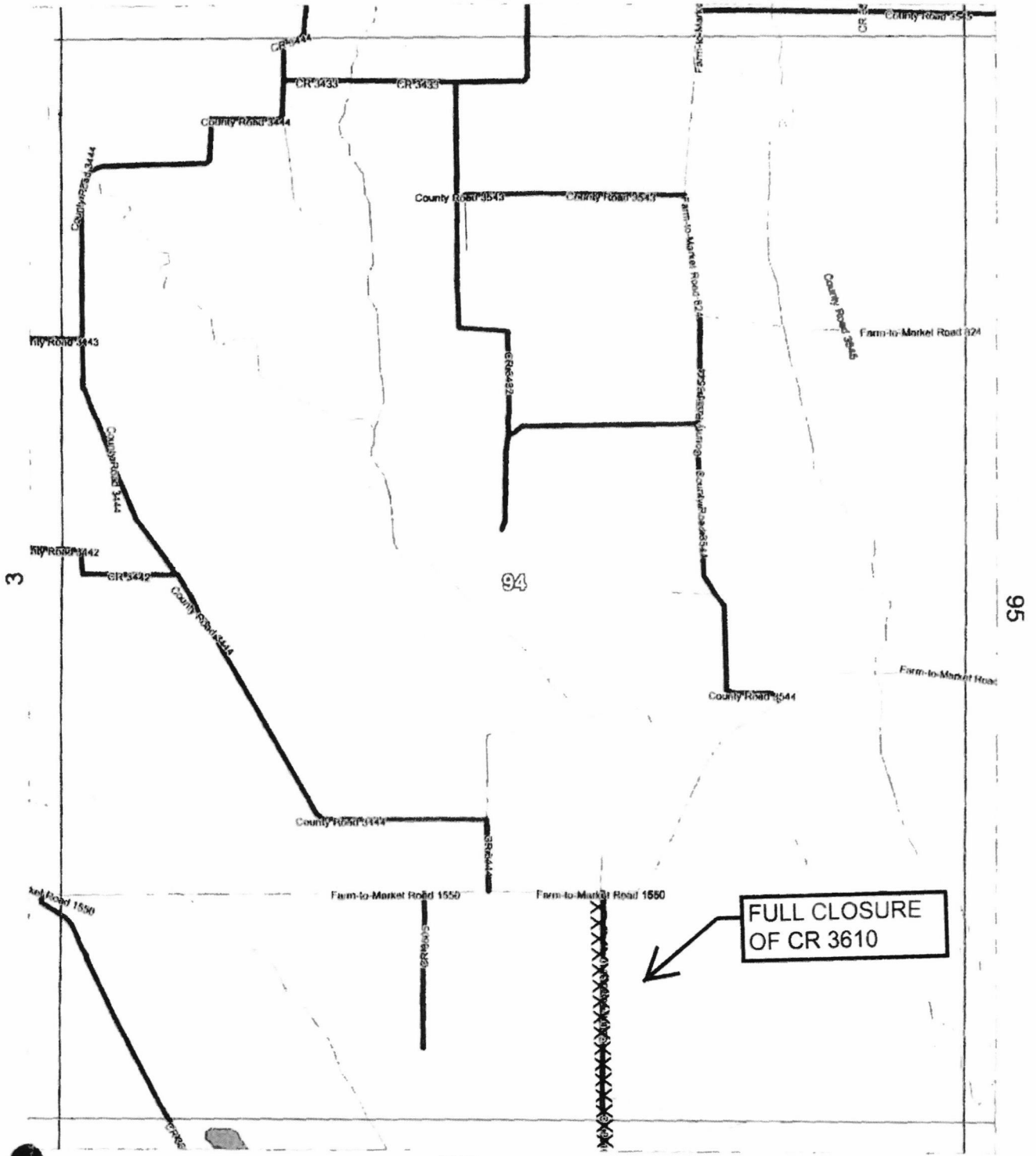

Allison, Bass & Assoc.
512-482-0701
R.Bass@Allison-Bass.com

Numbers Along Margins reflect
Page # of Adjacent Map Grids

3-Nov-2005
Map # 94

FULL CLOSURE
OF CR 3610